



JACKSON 1062

The Jackson casual contemporary track arm sofa features T-cushion seats and comes standard with decorative lumbar pillows for added comfort and style.

STANDARD FEATURES

Spring Construction: Sinuous

Seat Cushion: Cloud 9

Back Cushion: Blend Down

Lumbar Pillows: See Schematics

OVERALL DIMENSIONS

BODY DETAILS

Overall Depth: 42"

Overall Height: 35"

Frame Height: 32"

SEAT DETAILS

Seat Height: 18"

Seat Depth: 20" to Lumbar

ARM/LEG DETAILS

Arm Width: 7.5"

Arm Height: 25"

Leg Height: 2.5"

WOOD FINISH (Standard)

- Cream
- Milk
- Cloud
- Natural
- Sandalwood
- Caramel
- French Walnut
- Old Oak
- Umber
- Driftwood
- Shadow
- Black Walnut

WOOD FINISH (Premium)*

- Linen
- Pearl
- Sand
- Ash
- Putty
- Slate
- Shale
- Cavalier
- Rustic Gray
- Regent
- Zebra
- Black Lacquer

SEAT CUSHION FILL

- Cloud 9 (Standard)
- Luxe Aire*
- Down Supreme*
- Spring Down*
- Trillium*

BACK CUSHION FILL

- Blend Down (Standard)
- Regalaire*
- Down Supreme*
- Trillium*

FABRIC PATTERN: _____

FABRIC COLOR: _____

*Denotes Upcharge

AVAILABLE PIECES

(DRAWINGS NOT TO SCALE)

OTTOMANS/CHAIR/SOFAS

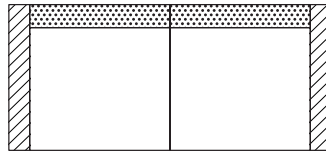

#40 - GRAND SOFA
102"W x 42"D

RIGHT ARM

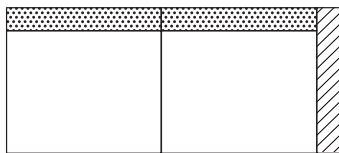

#73 - RIGHT ARM FACING/
LEFT SIDE ARMLESS
94.5"W x 42"D

LEFT ARM

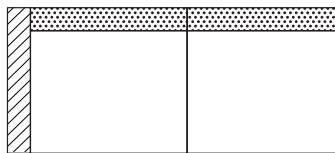

#63 - LEFT ARM FACING/
RIGHT SIDE ARMLESS
94.5"W x 42"D

ARMLESS

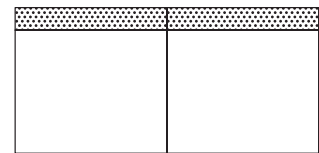

#53 - 3-CUSHION
ARMLESS
87"W x 42"D

CORNER/RIGHT ARM

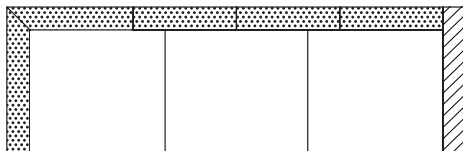

#34 - RIGHT ARM FACING/
LEFT SIDE CORNER
137"W x 42"D

CORNER/LEFT ARM

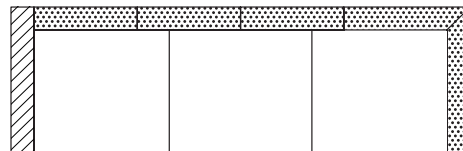

#24 - LEFT ARM FACING/
RIGHT SIDE CORNER
137"W x 42"D

CHAISE

CORNER

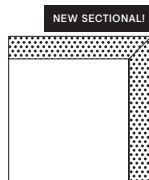

#41 - CORNER
42"W x 42"D



#48 - RIGHT ARM FACING/
LEFT SIDE ARMLESS
51"W x 70"D

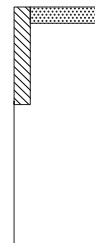

#46 - LEFT ARM FACING/
RIGHT SIDE ARMLESS
51"W x 70"D